

Stergio Valve™

The world's first auto-adjustable drainage system for the surgical treatment of glaucoma

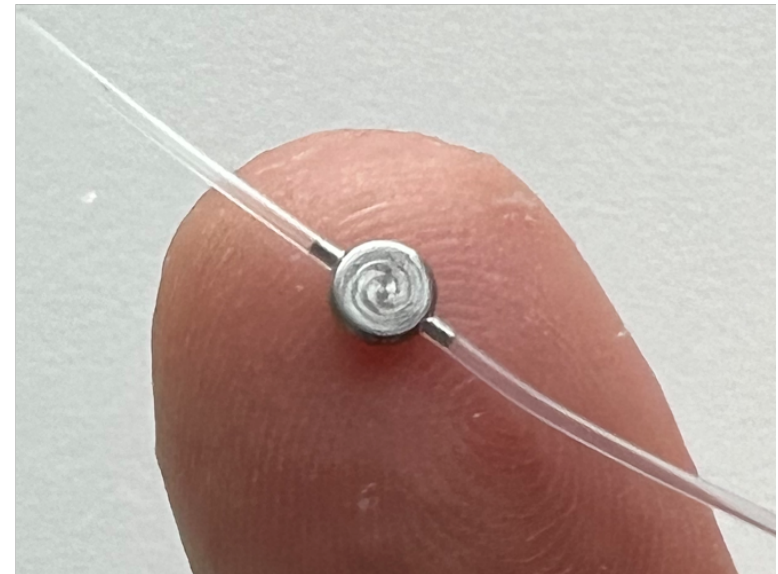

Rheon Medical product pipeline

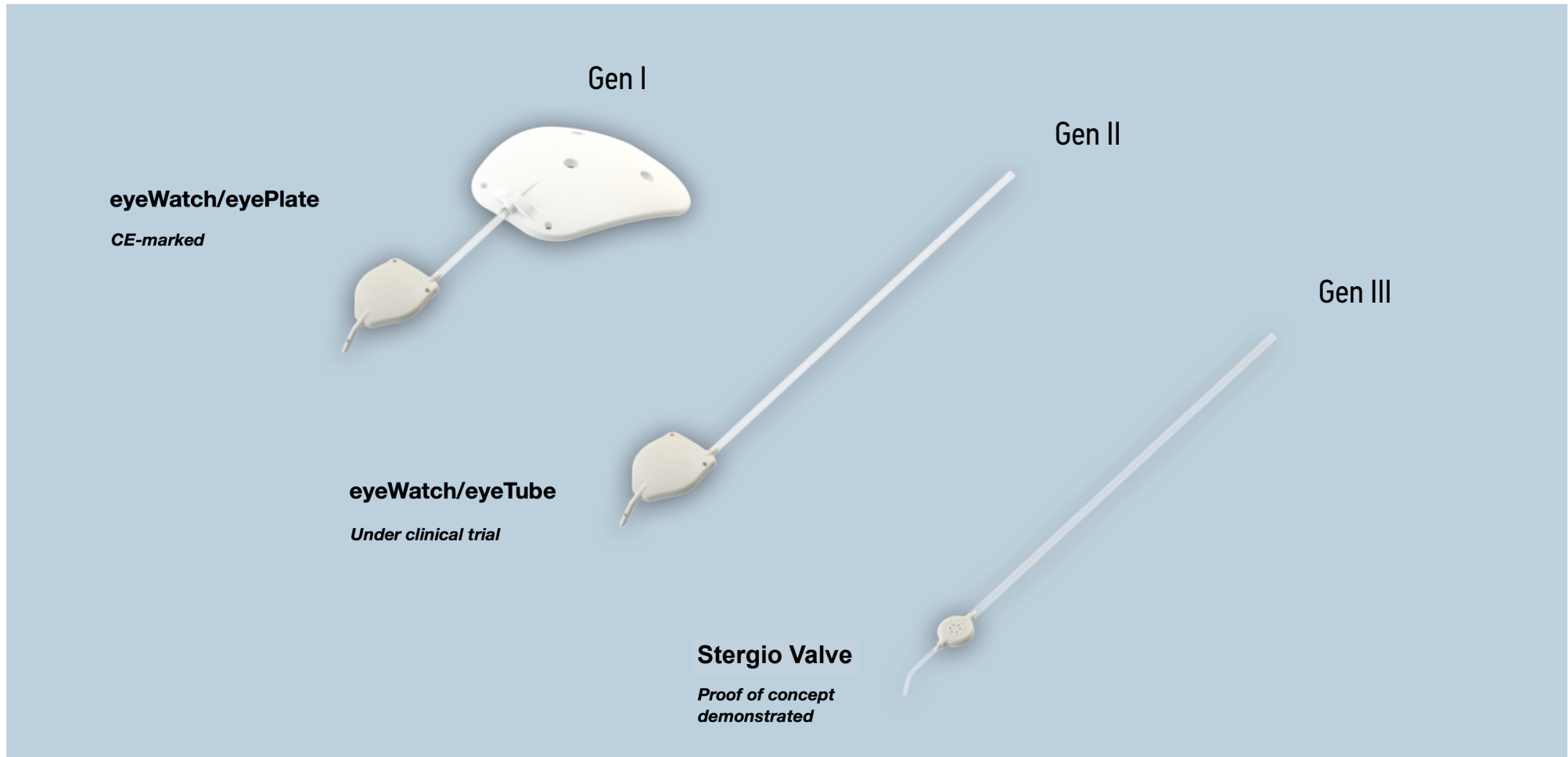

Pre-clinical results: Stergio Valve

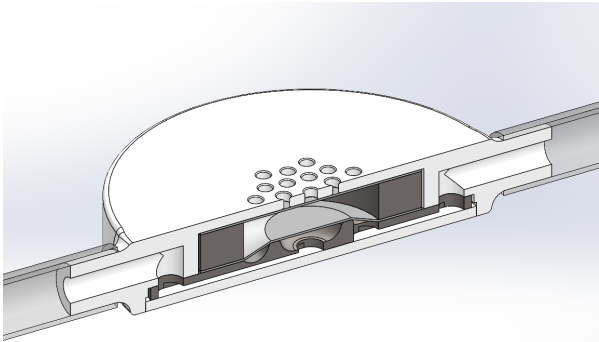

Schematic drawing of the Stergio Valve mechanism

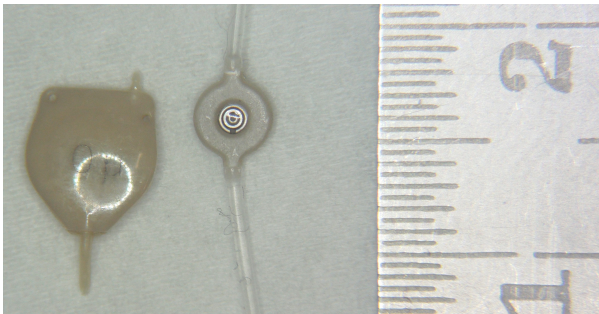

Photograph showing the real size comparison between the eyeWatch (left) and the Stergio Valve (right)

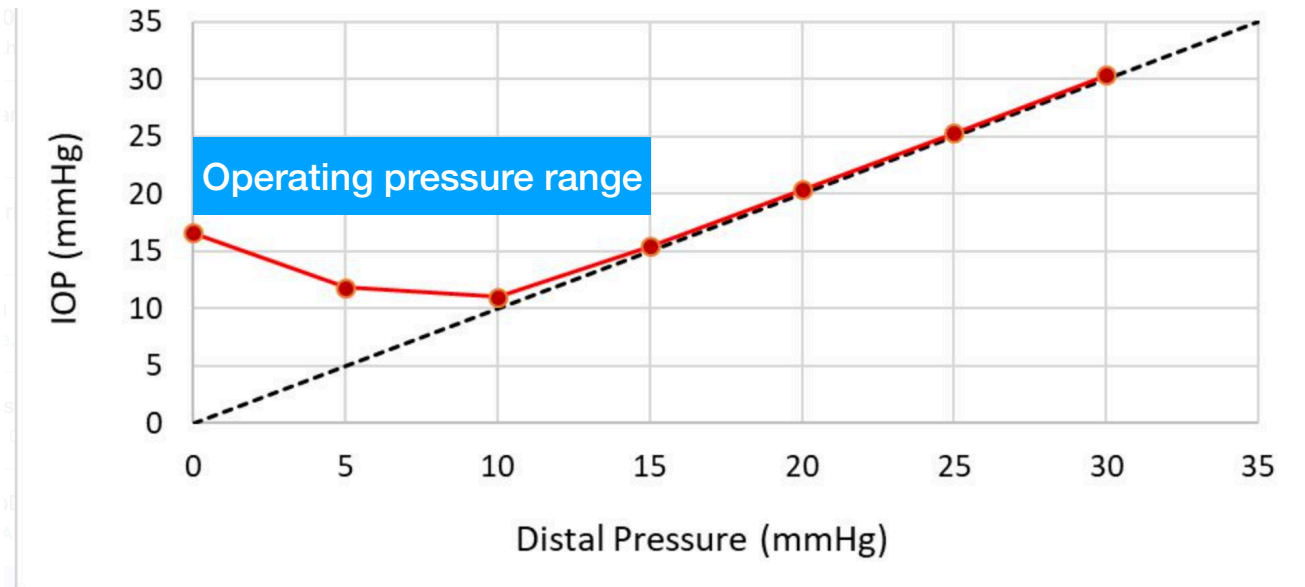

Preclinical results showing that the Stergio Valve maintains IOP relatively constant and within the targeted pressure range (12 - 16 mmHg) for a wide range of distal pressures (0 - 15 mmHg)